

FORM NO 1.

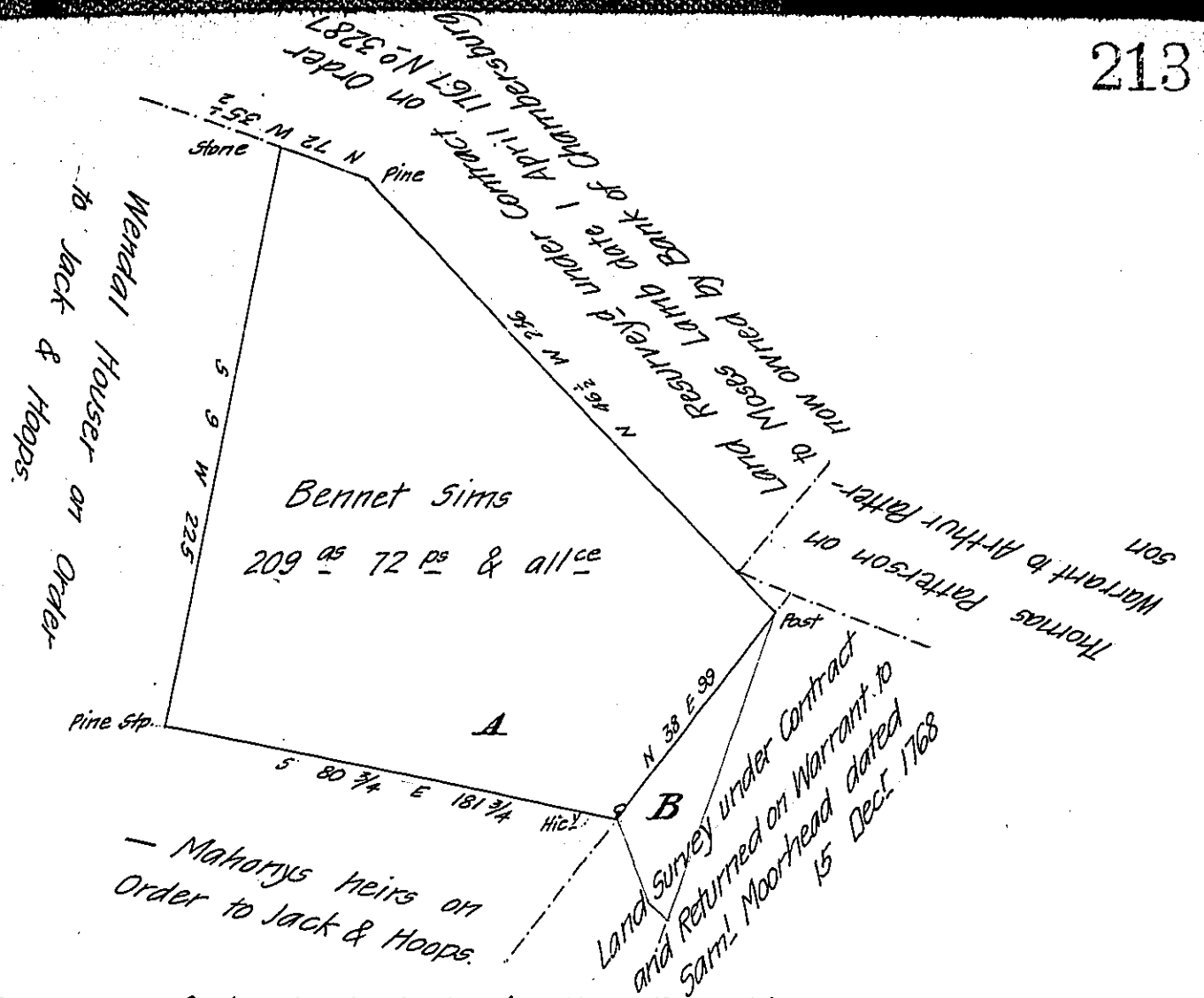

Draught of a Tract of Land situate in Hamilton Township Franklin County (formerly Cumberland) containing 209 acres 72 perches & allowance of six per Cent for roads & Survey'd 23^d October 1828 on an Order of Survey granted to Bennet Sims for 300 Acres "joining Samuel Moorhead Moses Lamb and Thomas Patterson in Hamilton Township" bearing date the 26th March 1767 No 3737. And in pursuance of a contract with the Board of Property for carrying into effect the

Several Acts of Assembly relating to unpatented Lands under Proprietary Rights &c. To Jacob Spangler Esq^r } Wm S. Davis }
 Surveyor General. } William Hamilton } Contractors

Report - The above described Tract marked A together with the red lined figure marked B has been covered by a Survey of 194 acres made for Benjamin Chambers the 30th June 1786 on Warrant to John Meck bearing date the 24th June 1785 and patent produced thereon J. Meck. Pat^d

Owner - The above Tract is owned in part by George Chambers Esq^r unseated and owned in part by Henry Ruby - Peter Eagle tenant on the land under Ruby - held under the title founded on Mecks Warrant

No evidence of any person claiming under the title to Sims W.S.D.
 George Chambers Esq^r and Henry Ruby, John Hade & John Shetter Owner
 Peter Eagle Occupant.

IN TESTIMONY that the above is a copy of the original remaining on file in the Department of Internal Affairs of Pennsylvania, made conformably to an Act of Assembly approved the 16th day of February, 1833, I have hereunto set my Hand and caused the Seal of said Department to be affixed at Harrisburg, this fourteenth day of August 1908

Henry Howell
 Secretary of Internal Affairs.